

**A57 Link Roads**

**TR010034**

**2.4 Streets, Rights of Way and Access  
Plans**

APFP Regulation 5(2)(k)

Planning Act 2008

Infrastructure Planning (Applications: Prescribed Forms and Procedure)  
Regulations 2009

February 2022

## Infrastructure Planning

### Planning Act 2008

## The Infrastructure Planning (Applications: Prescribed Forms and Procedure) Regulations 2009

### A57 Link Roads

### Development Consent Order 202[x]

---

#### 2.4 Streets, Rights of Way and Access Plans

---

<b>Regulation Number:</b>	Regulation 5(2)(k)
<b>Planning Inspectorate Scheme Reference</b>	TR010034
<b>Application Document Reference</b>	TR010034/APP/2.4
<b>Author:</b>	A57 Link Roads Project Team, National Highways and Atkins

<b>Version</b>	<b>Date</b>	<b>Status of Version</b>
Rev 3.0	February 2022	Deadline 5
Rev 2.0	November 2021	Section 51 Advice
Rev 1.0	June 2021	DCO Application

# Table of contents

Chapter	Pages
<b>1. Introduction</b>	<b>4</b>
1.1 Introduction and purpose of this document	4
1.2 Scope and format of the Streets, Rights of Way and Access Plans	4
<b>2. Schedule of plans included in this application document</b>	<b>5</b>

# 1. Introduction

## 1.1 Introduction and purpose of this document

- 1.1.1 National Highways (the “Applicant”) has applied to the Secretary of State for Development Consent Order (“DCO”) to determine the Applicant’s proposals for the creation of new link roads and alteration to the existing A57; A57 Link Roads (the “Scheme”). The application is submitted to the Planning Inspectorate (the “Inspectorate”) in accordance with section 37 of the Planning Act 2008 (the “2008 Act”).
- 1.1.2 This document comprises part of the suite of Application documents and is submitted to comply with Regulation 5(2)(k) of the Infrastructure Planning (Applications: Prescribed Forms and Procedure) Regulations 2009 (as amended), which requires:
- 5(2)(k) ‘where applicable, a plan identifying any new or altered means of access, stopping up of streets or roads or any diversions, extinguishments or creation of rights of way or public rights of navigation’.*
- 1.1.3 The purpose of the Streets, Rights of Way and Access Plans is to show streets, roads and public rights of way that are to be stopped up, diverted or extinguished and new highways, including public rights of way to be created and their intended highway classification. The Plans also show private means of access to be stopped-up, extinguished or altered and the substitute means of access to be provided. The Streets, Rights of Way and Access Plans have been prepared having regard to best practice and advice provided by the Planning Inspectorate under Section 51 of the Planning Act 2008.
- 1.1.4 The Streets, Rights of Way and Access Plans are submitted for approval and will be certified under article 45 of the DCO once the Order is made. As this document is part of a suite of Application documentation, it should be read alongside and is informed by other Application documents. In particular, the plans should be read alongside the Book of Reference (TR010034/APP/4.3 rev 3 submitted at Deadline 5) and Schedule 1 of the Development Consent Order (TR010034/APP/3.1 rev 3 submitted at Deadline 5).

## 1.2 Scope and format of the Streets, Rights of Way and Access Plans

- 1.2.1 This document should be read alongside and is informed by the other Application documents, in particular:
- Draft Development Consent Order  
Schedule 3: Classification of Roads etc.  
Schedule 4: Permanent Stopping Up Of Highways And Private Means Of Access & Provision Of New Highways And Private Means Of Access.



## 2. Schedule of plans included in this application document

Document title	Document number	Version
2.4 Streets, Rights of Way and Access Plan – Key Plan Regulation 5(4)	TR010034/APP/2.4 HE551473-BBA-LDC-A57_AL_SCHEME-DR-ZL-020400	<u>P02</u>
2.4 Streets, Rights of Way and Access Plan – Sheet 1 of 10 Regulation 5(2)(k)	TR010034/APP/2.4 HE551473-BBA-LDC-A57_AL_SCHEME-DR-ZL-020401	<u>P03P02</u>
2.4 Streets, Rights of Way and Access Plan – Sheet 2 of 10 Regulation 5(2)(k)	TR010034/APP/2.4 HE551473-BBA-LDC-A57_AL_SCHEME-DR-ZL-020402	<u>P03P02</u>
2.4 Streets, Rights of Way and Access Plan – Sheet 3 of 10 Regulation 5(2)(k)	TR010034/APP/2.4 HE551473-BBA-LDC-A57_AL_SCHEME-DR-ZL-020403	<u>P03P02</u>
2.4 Streets, Rights of Way and Access Plan – Sheet 4 of 10 Regulation 5(2)(k)	TR010034/APP/2.4 HE551473-BBA-LDC-A57_AL_SCHEME-DR-ZL-020404	<u>P03P02</u>
2.4 Streets, Rights of Way and Access Plan – Sheet 5 of 10 Regulation 5(2)(k)	TR010034/APP/2.4 HE551473-BBA-LDC-A57_AL_SCHEME-DR-ZL-020405	<u>P03P02</u>
2.4 Streets, Rights of Way and Access Plan – Sheet 6 of 10 Regulation 5(2)(k)	TR010034/APP/2.4 HE551473-BBA-LDC-A57_AL_SCHEME-DR-ZL-020406	<u>P03P02</u>
2.4 Streets, Rights of Way and Access Plan – Sheet 7 of 10 Regulation 5(2)(k)	TR010034/APP/2.4 HE551473-BBA-LDC-A57_AL_SCHEME-DR-ZL-020407	<u>P03P02</u>
2.4 Streets, Rights of Way and Access Plan – Sheet 8 of 10 Regulation 5(2)(k)	TR010034/APP/2.4 HE551473-BBA-LDC-A57_AL_SCHEME-DR-ZL-020408	<u>P03P02</u>
2.4 Streets, Rights of Way and Access Plan – Sheet 9 of 10 Regulation 5(2)(k)	TR010034/APP/2.4 HE551473-BBA-LDC-A57_AL_SCHEME-DR-ZL-020409	<u>P03P02</u>
2.4 Streets, Rights of Way and Access Plan – Sheet 10 of 10 Regulation 5(2)(k)	TR010034/APP/2.4 HE551473-BBA-LDC-A57_AL_SCHEME-DR-ZL-020410	<u>P03P02</u>



DO NOT SCALE

100  
Millimetres

0 10

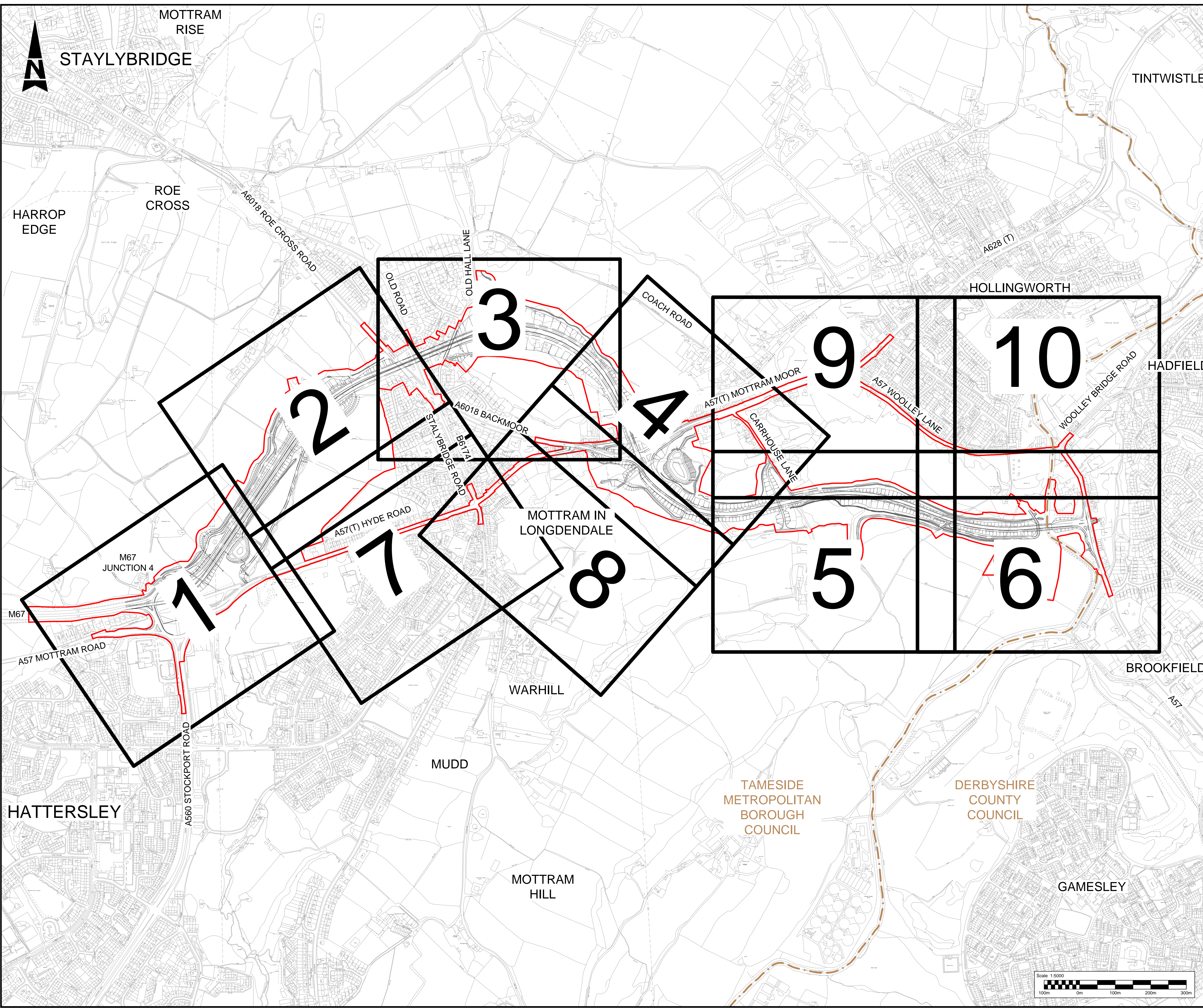

**NOTES**

1. THE PROPOSED WORKS WILL BE SUBJECT TO DETAILED DESIGN DEVELOPMENT. ANY CHANGES WILL BE LIMITED TO BEING WITHIN THE DCO BOUNDARY OR THE RELEVANT LIMITS OF DEVIATION, AND SUBJECT TO THE REQUIREMENTS OF SCHEDULE 2 OF THE DEVELOPMENT CONSENT ORDER (TR010034/APP/3.1).

**LEGEND**

- 3 SHEET NUMBER FOR PROPOSED WORKS TO STREETS, RIGHTS OF WAY, AND ACCESSES SHOWN IN THIS AREA.
- DEVELOPMENT CONSENT ORDER (DCO) BOUNDARY
- LOCAL AUTHORITY BOUNDARY

This map is based on Ordnance Survey material with the permission of Ordnance Survey on behalf of the Controller of Her Majesty's Stationary Office. © Crown copyright. Unauthorised reproduction infringes Crown copyright and may lead to prosecution or civil proceedings. Highways England 10003649, 2021.

Status	Revision	Issue Date

Description

Status	Revision	Issue Date

Description

Status	Revision	Issue Date

DCO APPLICATION			
Status	Revision	Issue Date	
A4	P01	14/05/21	

S51 ADVICE			
Status	Revision	Issue Date	
A4	P02	17/11/21	

Drawing Suitability	Status
DCO APPLICATION	A4

Client

Scheme Name  
**A57 LINK ROADS**

Drawing Title  
**STREETS, RIGHTS OF WAY AND ACCESS KEY PLAN REGULATION 5(4) SHEET 1 OF 1**

PINS Ref No:  
TR010034/APP/2.4

Drawing Number	Originator	Volume
HE551473	BBA	LDC

Location	Type	Role	Number
A57_AL_SCHEME	DR	ZL	020400

Scale	Original Size	Rev
1:5000 @ A1	A1	P02



DO NOT SCALE

Millimetres

0 10

100

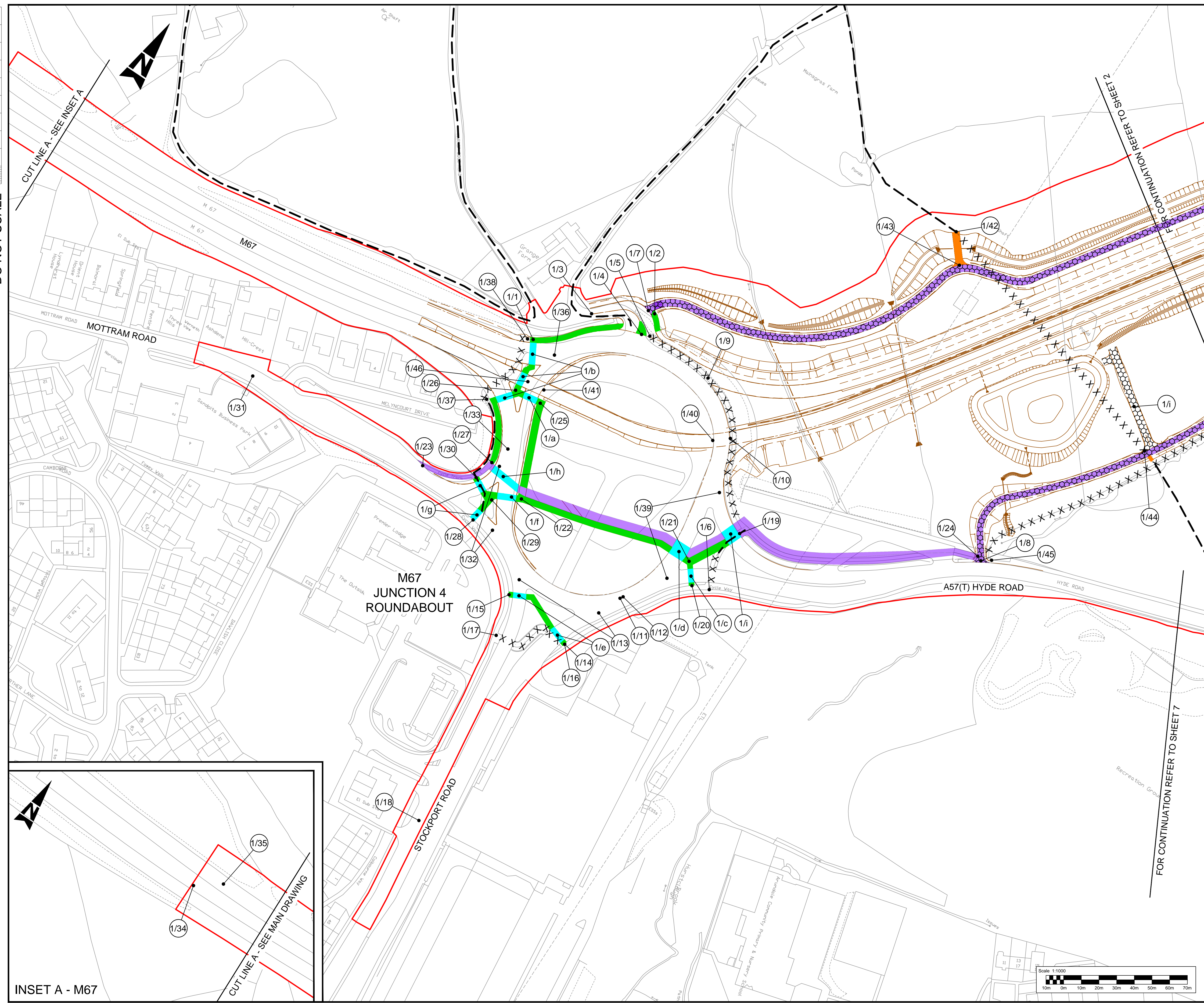

**Notes**

- These plans should be read in conjunction with Schedules 3 and 4 of the Development Consent Order (application document reference TR010034/APP/3.1).

**Legend:**

- Local Authority boundary
- Development Consent Order (DCO) boundary
- Scheme layout (shown for illustrative purposes)
- Existing highways to be stopped up
- Private means of access to be stopped up
- New/alterd private means of access
- Existing Public Right of Way (PRoW)
- PRoW or footway/cycleway to be stopped up/extinguished
- New or diverted combined footway/cycleway with equestrian use
- New or diverted footway
- New or diverted footpath
- New non-segregated footway/cycle track
- New private means of access to maintain ecology mitigation
- Start/End point of highway / right of way to be improved, diverted, created, stopped up or extinguished
- New signal controlled non-motorised user crossing
- Existing private means of access to be stopped up
- Other private means of access to be altered

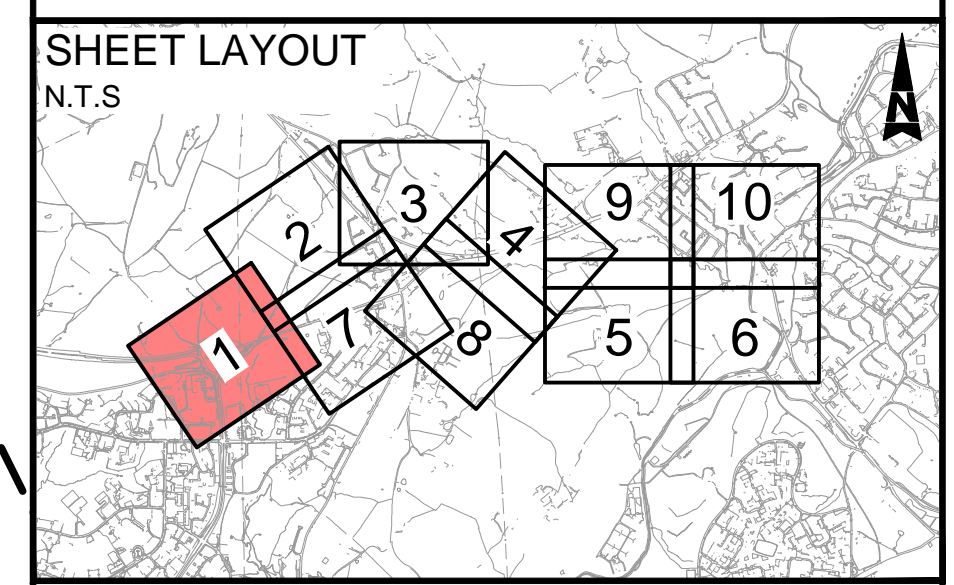

This map is based on Ordnance Survey material with the permission of Ordnance Survey on behalf of the Controller of Her Majesty's Stationary Office. © Crown copyright. Unauthorised reproduction infringes Crown copyright and may lead to prosecution or civil proceedings. Highways England 10003646, 2021.

Description	Status	Revision	Issue Date
DCO APPLICATION	A4	P01	14/05/21
S51 ADVICE	A4	P02	17/11/21
Updated for Deadline 5	A4	P03	23/02/22

Drawing Suitability	DCO APPLICATION	Status	A4
---------------------	-----------------	--------	----

Client:

Scheme Name: **A57 LINK ROADS**

Drawing Title: **STREETS, RIGHTS OF WAY AND ACCESS PLANS REGULATION 5(2)(k) SHEET 1 OF 10**

PINS Ref No: TR010034/APP/2.4

Drawing Number	HE551473	Originator	BBA	Volume	LDC
Location	A57_AL_SCHEME	Type	DR	Role	ZL
Scale	1:1000 @ A1	Original Size	A1	Rev	P03

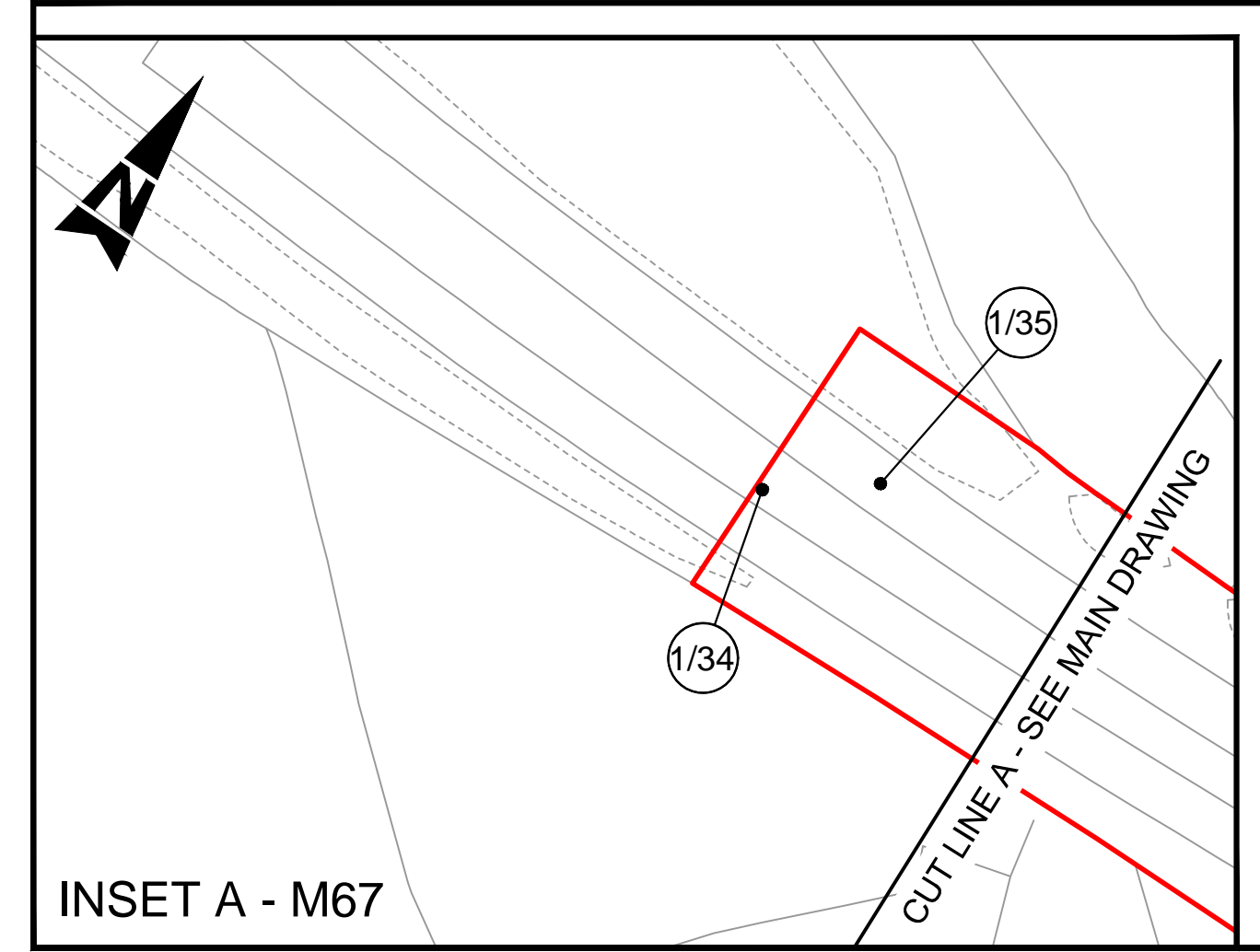



DO NOT SCALE

Millimetres  
0 10 100

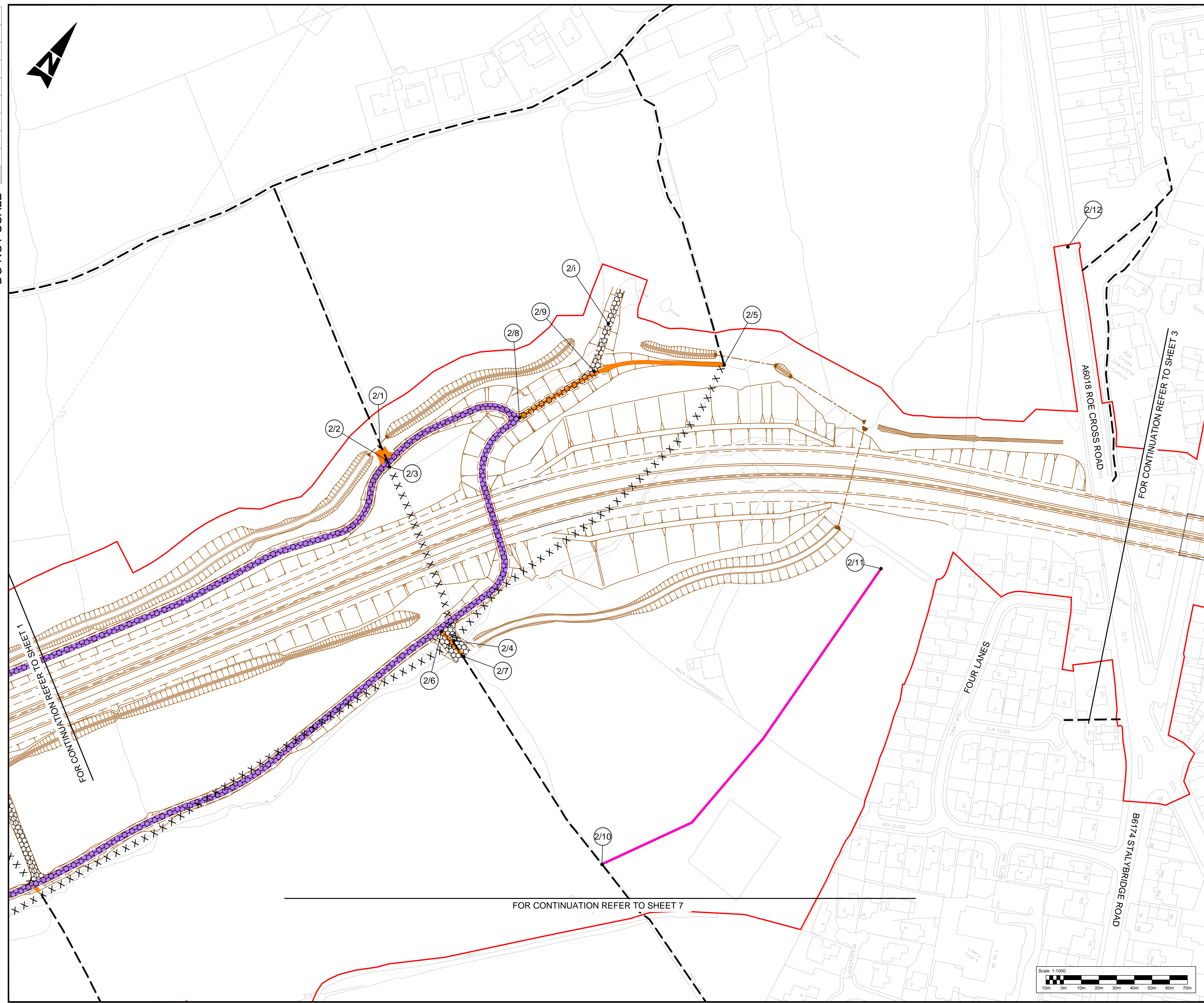
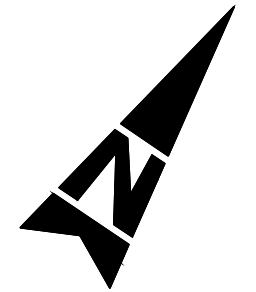

**Notes**

1. These plans should be read in conjunction with Schedules 3 and 4 of the Development Consent Order (application document reference TR010034/APP/3.1).

**Legend:**

- Local Authority boundary
- Development Consent Order (DCO) boundary
- Scheme layout (shown for illustrative purposes)
- Existing highways to be stopped up
- Private means of access to be stopped up
- New/alterd private means of access
- Existing Public Right of Way (PRoW)
- PRoW or footway/cycleway to be stopped up/extinguished
- New or diverted combined footway/cycleway with equestrian use
- New or diverted footway
- New or diverted footpath
- New non-segregated footway/cycle track
- New private means of access to maintain ecology mitigation
- Start/End point of highway / right of way to be improved, diverted, created, stopped up or extinguished
- New signal controlled non-motorised user crossing
- Existing private means of access to be stopped up
- Other private means of access to be altered

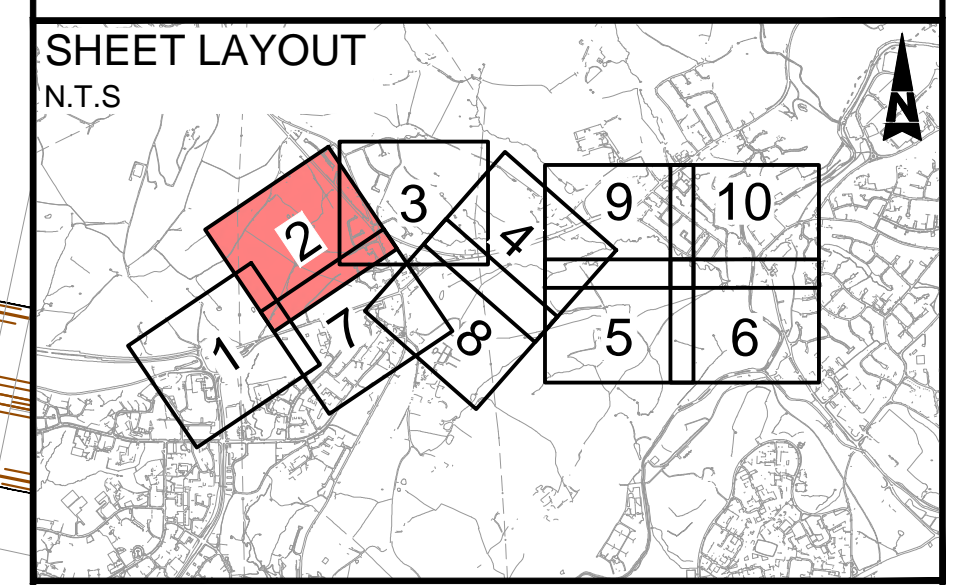

This map is based on Ordnance Survey material with the permission of Ordnance Survey on behalf of the Controller of Her Majesty's Stationery Office. © Crown copyright. Unauthorised reproduction infringes Crown copyright and may lead to prosecution or civil proceedings. Highways England 100036649, 2021.

Description	Status	Revision	Issue Date
DCO APPLICATION	Status	A4	Revision P01 Issue Date 14/05/21
S51 ADVICE	Status	A4	Revision P02 Issue Date 17/11/21
Updated for Deadline 5	Status	A4	Revision P03 Issue Date 23/02/22

Drawing Suitability	DCO APPLICATION	Status	A4
Client			
Scheme Name	A57 LINK ROADS		
Drawing Title	STREETS, RIGHTS OF WAY AND ACCESS PLANS REGULATION 5(2)(k) SHEET 2 OF 10		
PINS Ref No:	TR010034/APP/2.4		
Drawing Number	HE551473	Originator	BBA
Volume	LDC		
Location	A57_AL_SCHEME	Type	DR
Role	ZL	Number	020402
Scale:	1:1000 @ A1	Original Size:	A1
Rev:	P03		

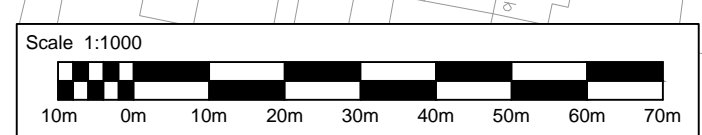



DO NOT SCALE

Millimetres 0 10 100

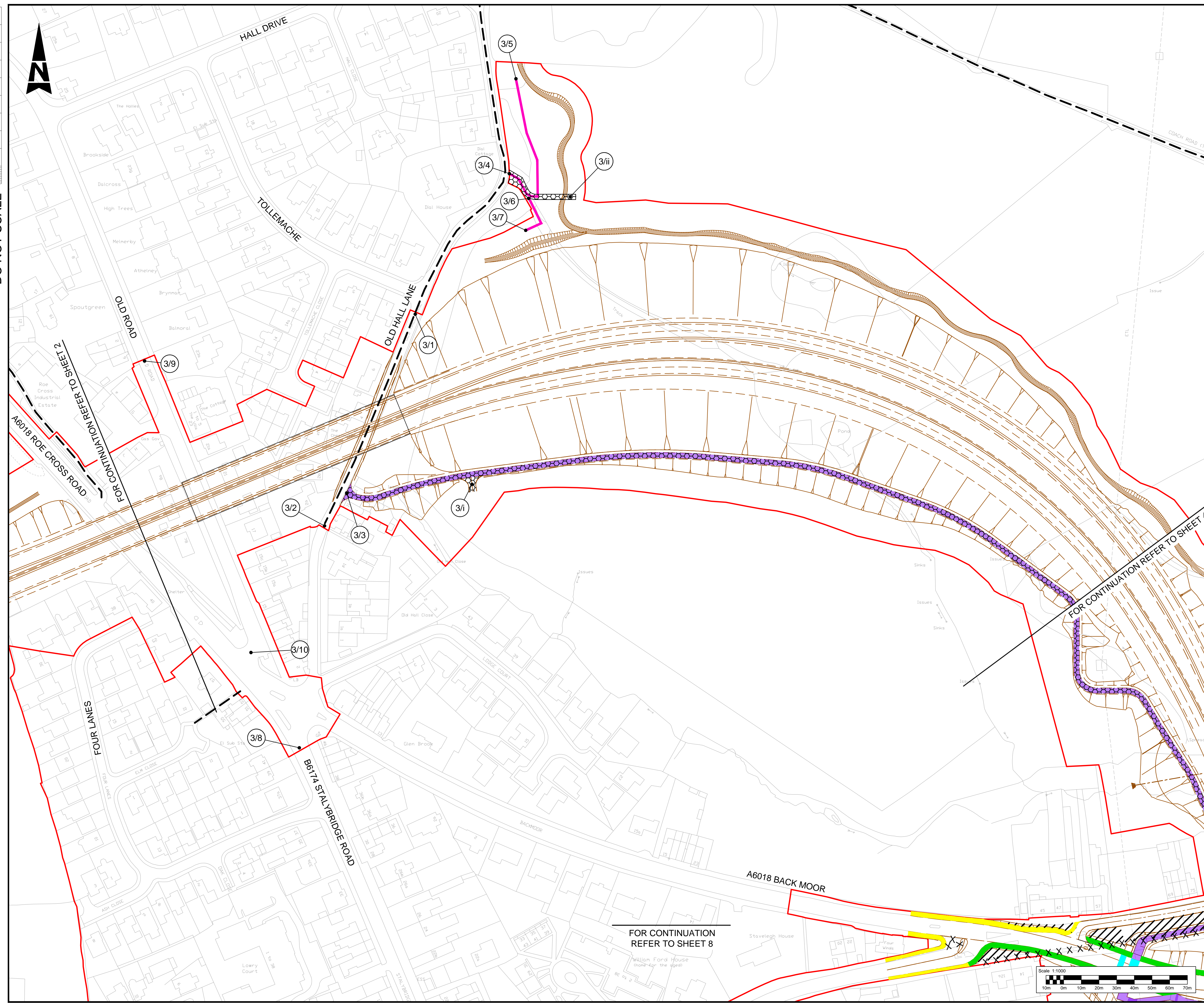

**Notes**

1. These plans should be read in conjunction with Schedules 3 and 4 of the Development Consent Order (application document reference TR010034/APP/3.1).

**Legend:**

- Local Authority boundary
- Development Consent Order (DCO) boundary
- Scheme layout (shown for illustrative purposes)
- Existing highways to be stopped up
- Private means of access to be stopped up
- New/alterd private means of access
- Existing Public Right of Way (PRoW)
- PRoW or footway/cycleway to be stopped up/extinguished
- New or diverted combined footway/cycleway with equestrian use
- New or diverted footway
- New or diverted footpath
- New non-segregated footway/cycle track
- New private means of access to maintain ecology mitigation
- Start/End point of highway / right of way to be improved, diverted, created, stopped up or extinguished
- New signal controlled non-motorised user crossing
- Existing private means of access to be stopped up
- Other private means of access to be altered

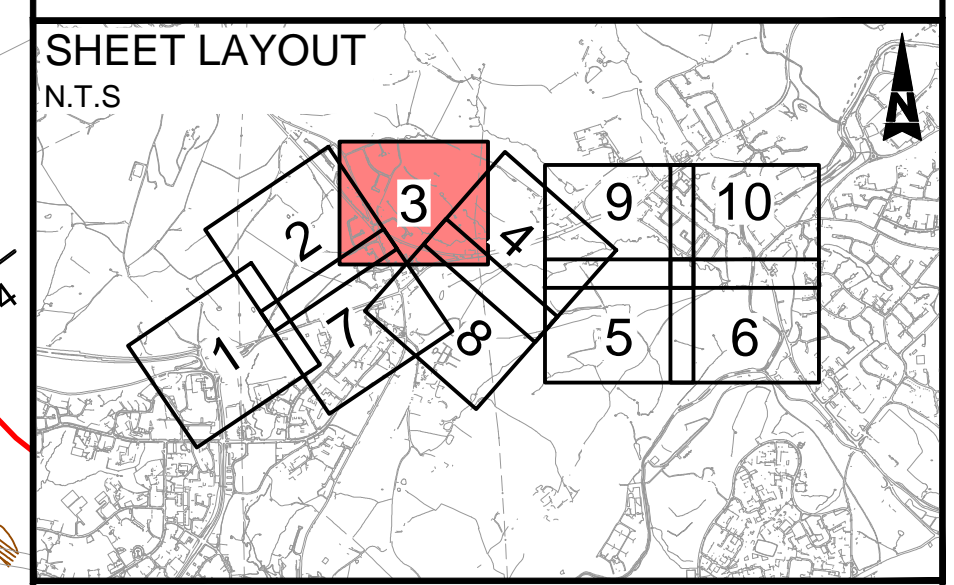

This map is based on Ordnance Survey material with the permission of Ordnance Survey on behalf of the Controller of Her Majesty's Stationery Office. © Crown copyright. Unauthorised reproduction infringes Crown copyright and may lead to prosecution or civil proceedings. Highways England 100036649, 2021.

Description	Status	Revision	Issue Date
DCO APPLICATION	A4	P01	14/05/21
S51 ADVICE	A4	P02	17/11/21
Updated for Deadline 5	A4	P03	23/02/22

Drawing Suitability	DCO APPLICATION	Status	A4
---------------------	-----------------	--------	----



**Scheme Name**  
A57 LINK ROADS

**Drawing Title**  
STREETS, RIGHTS OF WAY AND ACCESS PLANS  
REGULATION 5(2)(K)  
SHEET 3 OF 10

**PINS Ref No:** TR010034/APP/2.4

<b>Drawing Number</b> Scheme	HE551473	<b>Originator</b> Scheme	BBA	<b>Volume</b> Scheme	LDC
<b>Location</b>	A57_AL_SCHEME	<b>Type</b>	DR	<b>Role</b>	ZL
<b>Scale</b>	1:1000 @ A1	<b>Original Size</b>	A1	<b>Rev</b>	P03

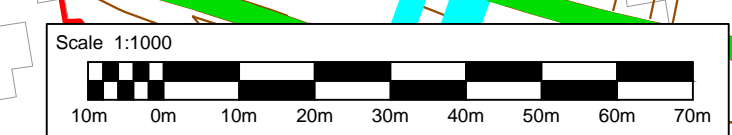



DO NOT SCALE

Millimetres  
0 10 100

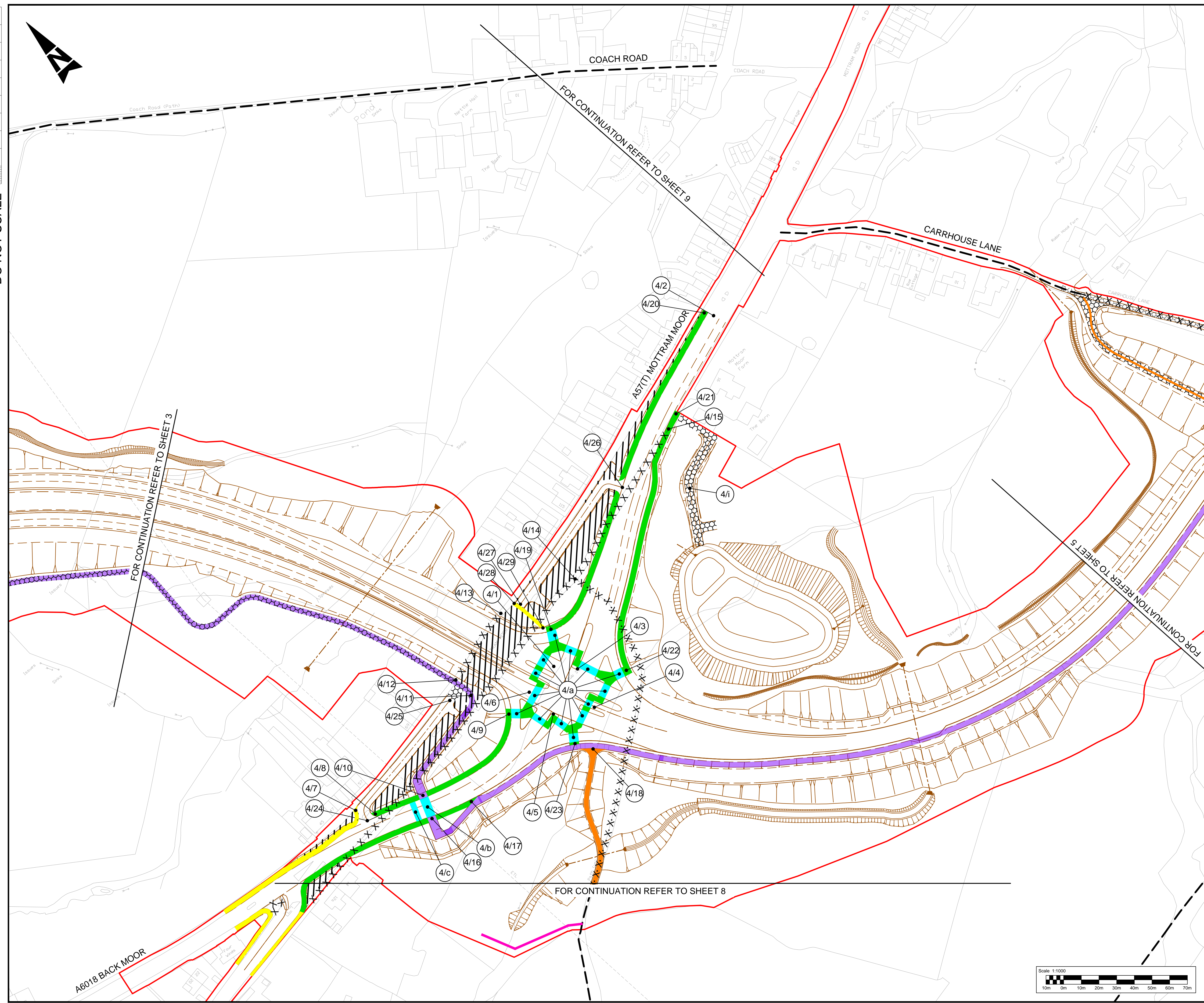
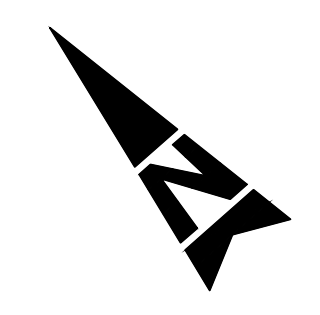

**Notes**

- These plans should be read in conjunction with Schedules 3 and 4 of the Development Consent Order (application document reference TR010034/APP/3.1).

**Legend:**

- Local Authority boundary
- Development Consent Order (DCO) boundary
- Scheme layout (shown for illustrative purposes)
- Existing highways to be stopped up
- Private means of access to be stopped up
- New/alterd private means of access
- Existing Public Right of Way (PRoW)
- PRoW or footway/cycleway to be stopped up/extinguished
- New or diverted combined footway/cycleway with equestrian use
- New or diverted footway
- New or diverted footpath
- New non-segregated footway/cycle track
- New private means of access to maintain ecology mitigation

(8/2) Start/End point of highway / right of way to be improved, diverted, created, stopped up or extinguished  
 (1/a) New signal controlled non-motorised user crossing  
 (A) Existing private means of access to be stopped up  
 (9/i) Other private means of access to be altered

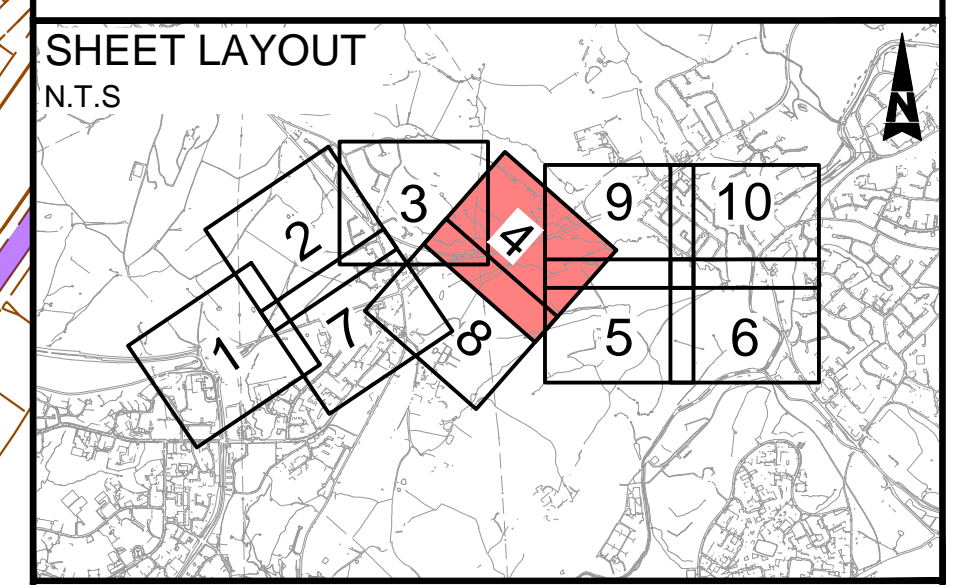

This map is based on Ordnance Survey material with the permission of Ordnance Survey on behalf of the Controller of Her Majesty's Stationary Office. © Crown copyright. Unauthorised reproduction infringes Crown copyright and may lead to prosecution or civil proceedings. Highways England 10003646, 2022.

Description	Status	Revision	Issue Date
DCO APPLICATION	A4	P01	14/05/21
S51 ADVICE	A4	P02	17/11/21
Updated for Deadline 5	A4	P03	23/02/22

Drawing Suitability	DCO APPLICATION	Status	A4
---------------------	-----------------	--------	----



Client	highways england		
Scheme Name	A57 LINK ROADS		
Drawing Title	STREETS, RIGHTS OF WAY AND ACCESS PLANS REGULATION 5(2)(k) SHEET 4 OF 10		
PINS Ref. No:	TR010034/APP/2.4		
Drawing Number	HE551473	Originator	BBA
Scheme	A57_AL_SCHEME	Volume	LDC
Location	DR	Role	ZL
Scale:	1:1000 @ A1	Original Size:	A1
Rev:	P03	Number	020404

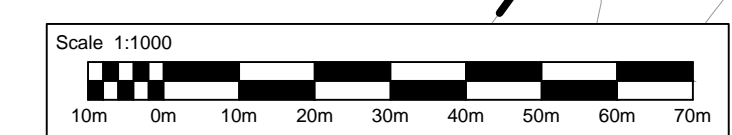



DO NOT SCALE

Millimetres  
0 10 100

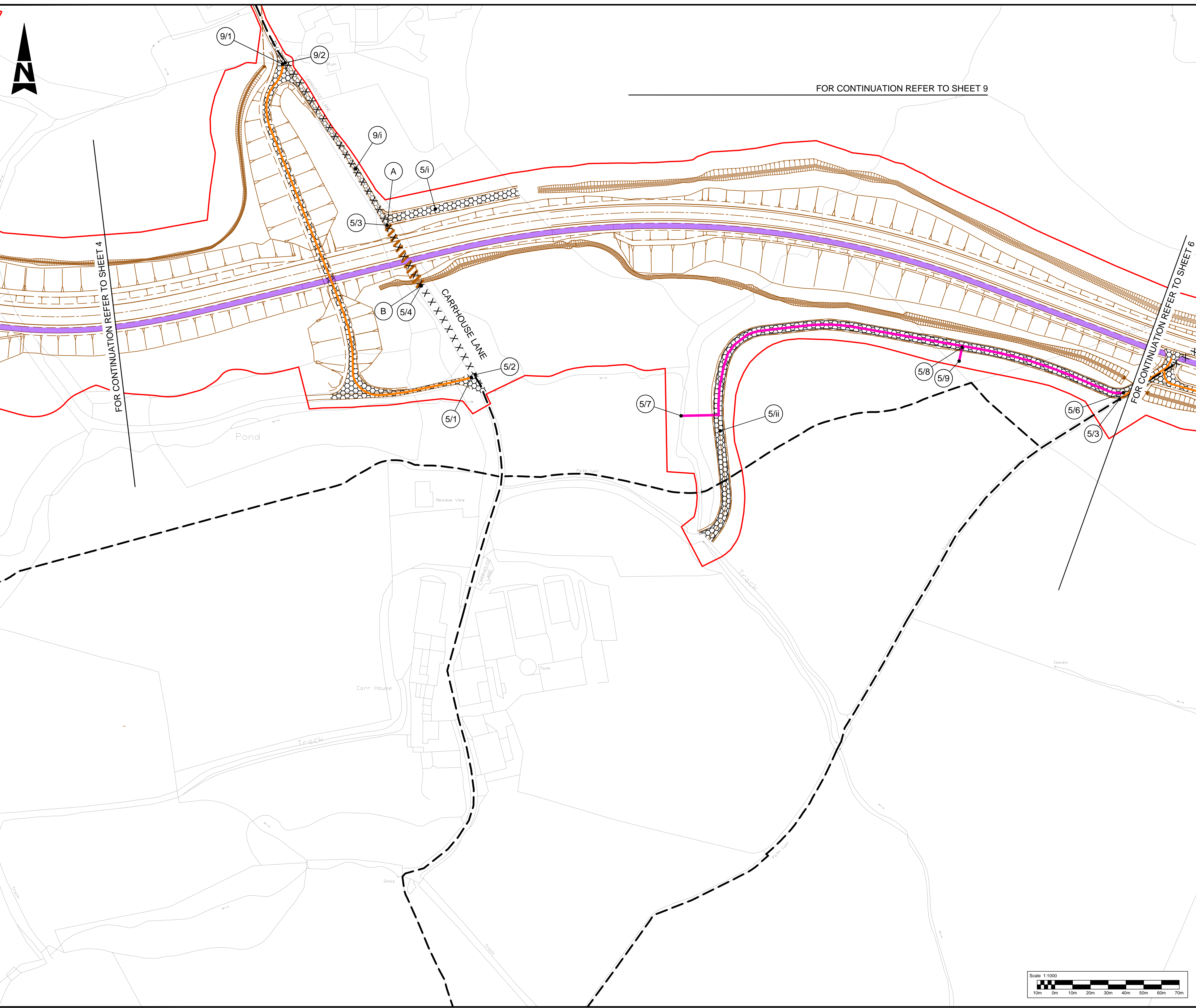

FOR CONTINUATION REFER TO SHEET 9

FOR CONTINUATION REFER TO SHEET 4

FOR CONTINUATION REFER TO SHEET 6

**Notes**

- These plans should be read in conjunction with Schedules 3 and 4 of the Development Consent Order (application document reference TR010034/APP/3.1).

**Legend:**

- Local Authority boundary
- Development Consent Order (DCO) boundary
- Scheme layout (shown for illustrative purposes)
- Existing highways to be stopped up
- Private means of access to be stopped up
- New/alterd private means of access
- Existing Public Right of Way (PRoW)
- PRoW or footway/cycleway to be stopped up/extinguished
- New or diverted combined footway/cycleway with equestrian use
- New or diverted footway
- New or diverted footpath
- New non-segregated footway/cycle track
- New private means of access to maintain ecology mitigation

- Start/End point of highway / right of way to be improved, diverted, created, stopped up or extinguished
- New signal controlled non-motorised user crossing
- Existing private means of access to be stopped up
- Other private means of access to be altered

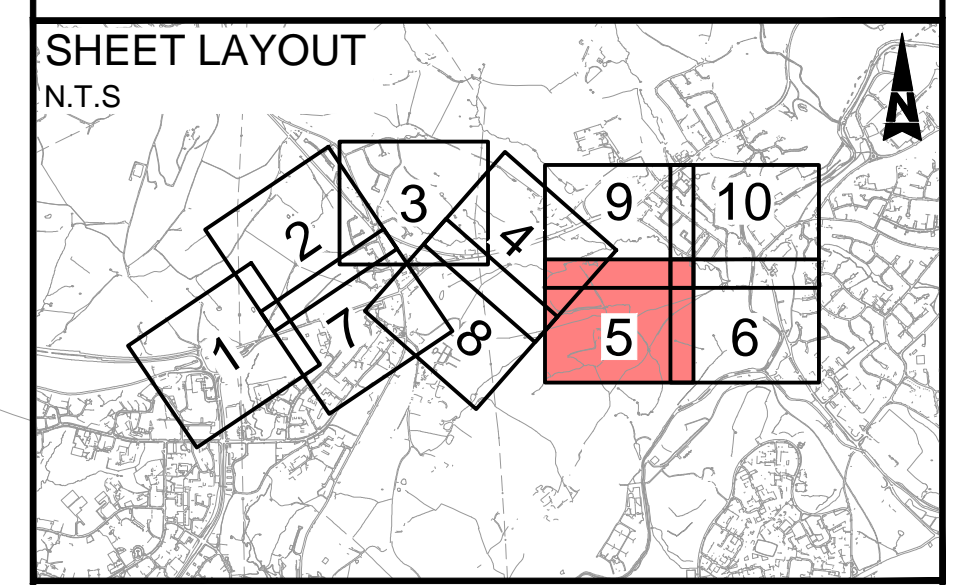

This map is based on Ordnance Survey material with the permission of Ordnance Survey on behalf of the Controller of Her Majesty's Stationery Office. © Crown copyright. Unauthorised reproduction infringes Crown copyright and may lead to prosecution or civil proceedings. Highways England 10003649, 2021.

Description	Status	Revision	Issue Date
DCO APPLICATION	A4	P01	14/05/21
S51 ADVICE	A4	P02	17/11/21
Updated for Deadline 5	A4	P03	23/02/22

Drawing Suitability	Status
DCO APPLICATION	A4



**Scheme Name**  
A57 LINK ROADS

**Drawing Title**  
STREETS, RIGHTS OF WAY AND ACCESS PLANS  
REGULATION 5(2)(k)  
SHEET 5 OF 10

**PINS Ref. No:** TR010034/APP/2.4

Drawing Number	Originator	Volume
HE551473	BBA	LDC
A57_AL_SCHEME · DR · ZL · 020405		
Location	Type	Role
	DR	ZL
Scale:	Original Size:	Rev:
1:1000 @ A1	A1	P03

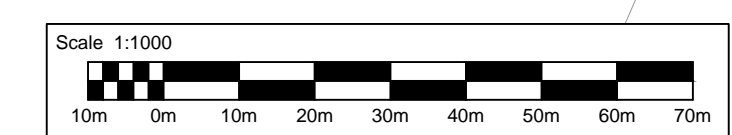



DO NOT SCALE

Millimetres  
0 10 100

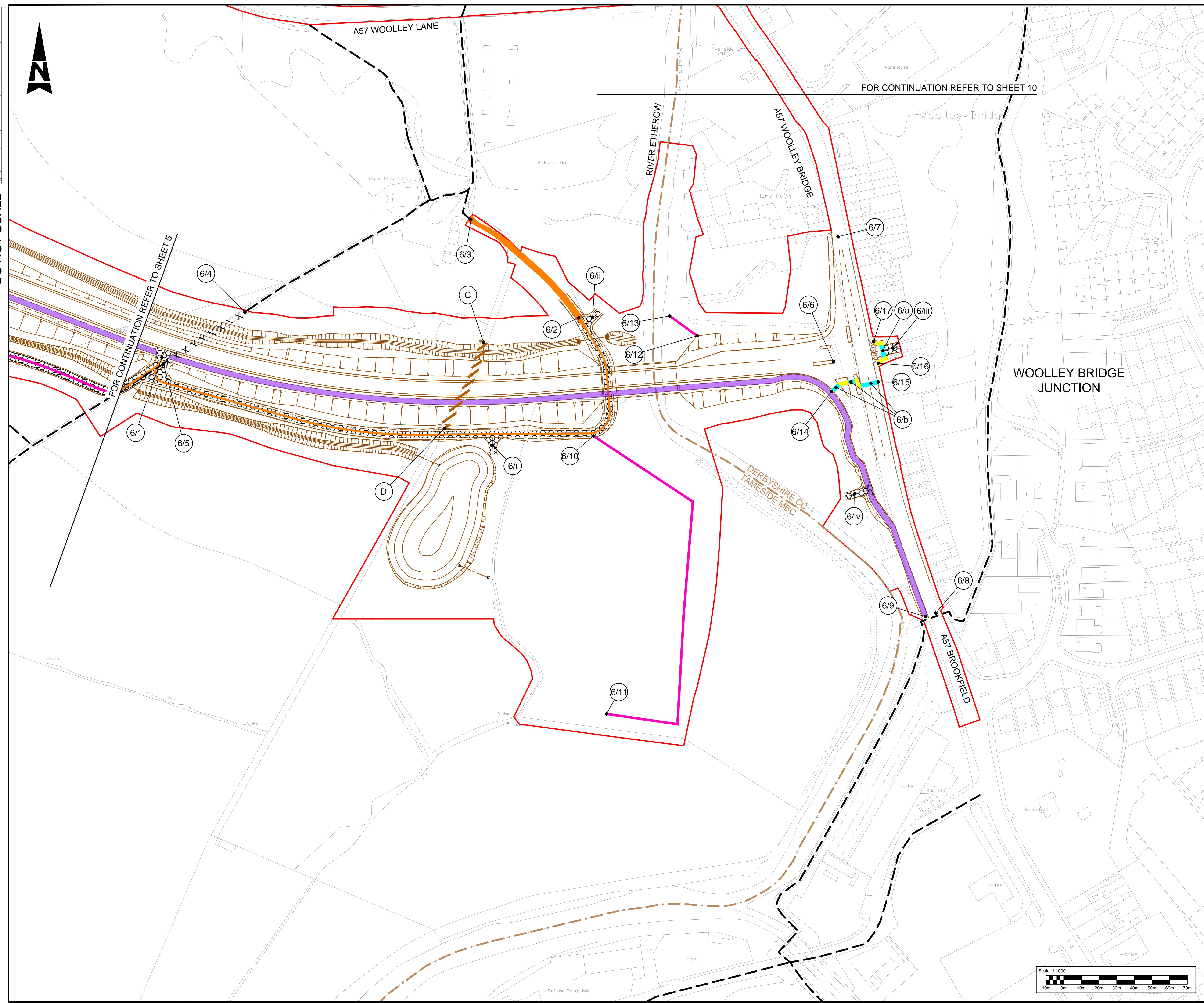
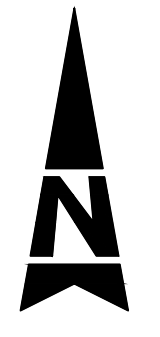

FOR CONTINUATION REFER TO SHEET 10

FOR CONTINUATION REFER TO SHEET 5

**Notes**

- These plans should be read in conjunction with Schedules 3 and 4 of the Development Consent Order (application document reference TR010034/APP/3.1).

**Legend:**

- Local Authority boundary
- Development Consent Order (DCO) boundary
- Scheme layout (shown for illustrative purposes)
- Existing highways to be stopped up
- Private means of access to be stopped up
- New/alterd private means of access
- Existing Public Right of Way (PRoW)
- PRoW or footway/cycleway to be stopped up/extinguished
- New or diverted combined footway/cycleway with equestrian use
- New or diverted footway
- New or diverted footpath
- New non-segregated footway/cycle track
- New private means of access to maintain ecology mitigation
- Start/End point of highway / right of way to be improved, diverted, created, stopped up or extinguished
- New signal controlled non-motorised user crossing
- Existing private means of access to be stopped up
- Other private means of access to be altered

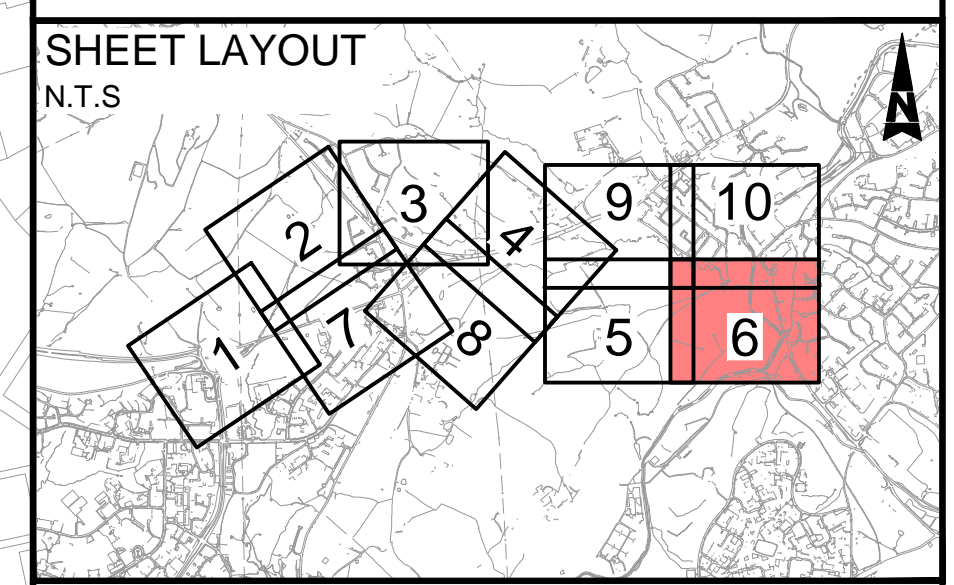

This map is based on Ordnance Survey material with the permission of Ordnance Survey on behalf of the Controller of Her Majesty's Stationary Office. © Crown copyright. Unauthorised reproduction infringes Crown copyright and may lead to prosecution or civil proceedings. Highways England 100030640, 2021.

Description	Status	Revision	Issue Date
DCO APPLICATION	A4	P01	14/05/21
S51 ADVICE	A4	P02	17/11/21
Updated for Deadline 5	A4	P03	23/02/22

Drawing Suitability	DCO APPLICATION	Status	A4
---------------------	-----------------	--------	----



**Scheme Name**  
A57 LINK ROADS

**Drawing Title**  
STREETS, RIGHTS OF WAY AND ACCESS PLANS  
REGULATION 5(2)(k)  
SHEET 6 OF 10

**PINS Ref No:**  
TR010034/APP/2.4

<b>Drawing Number</b> HE551473	<b>Originator</b> BBA	<b>Volume</b> LDC
<b>Location</b> A57_AL_SCHEME	<b>Type</b> DR	<b>Role</b> ZL
<b>Scale</b> 1:1000 @ A1	<b>Original Size</b> A1	<b>Rev</b> P03

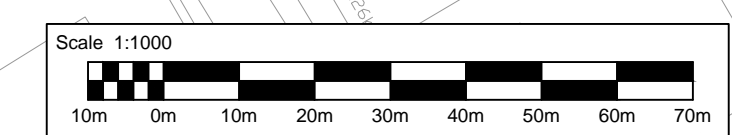



100  
0 10  
Millimetres  
DO NOT SCALE

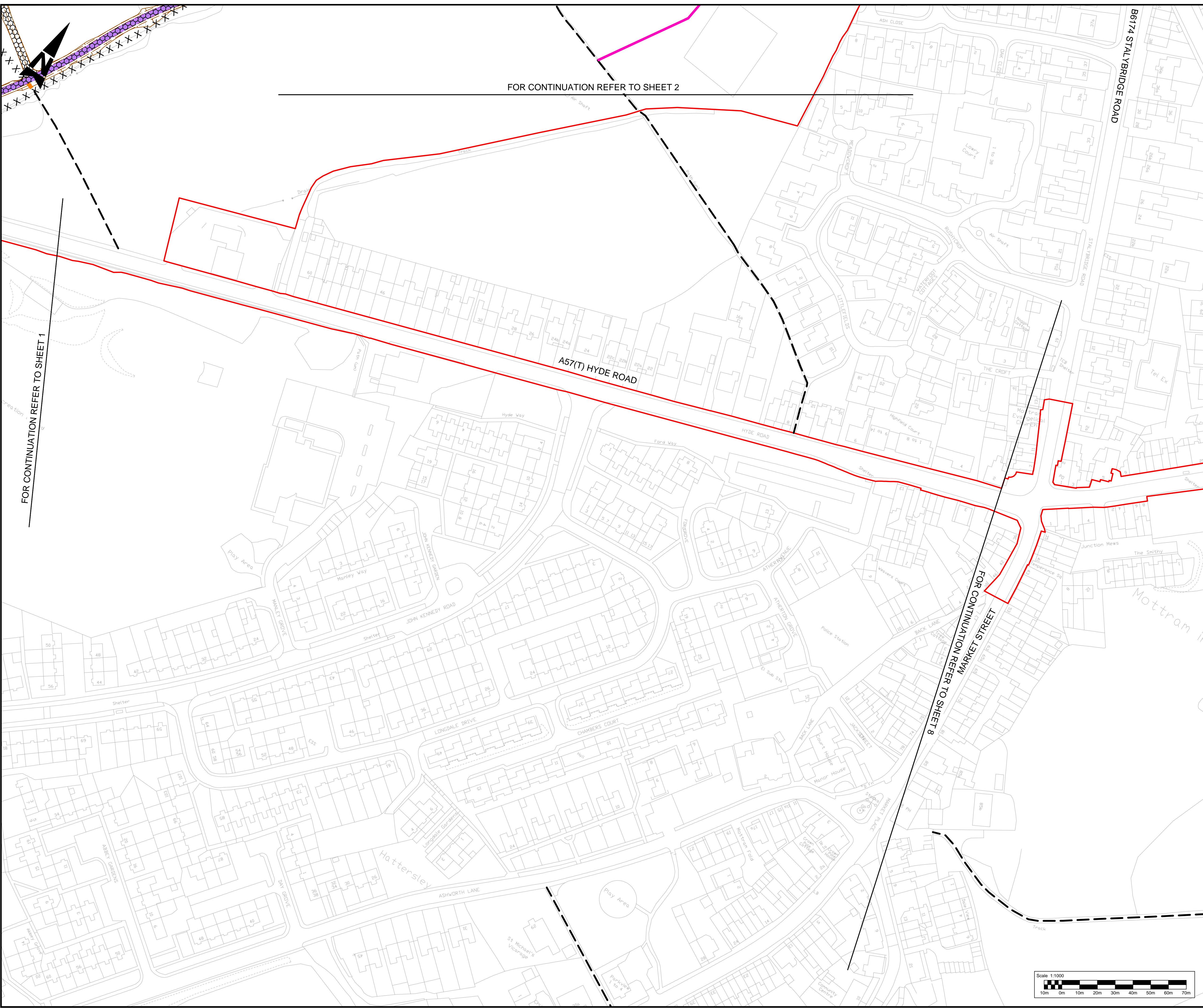

FOR CONTINUATION REFER TO SHEET 2

FOR CONTINUATION REFER TO SHEET 1

FOR CONTINUATION REFER TO SHEET 8

**Notes**

- These plans should be read in conjunction with Schedules 3 and 4 of the Development Consent Order (application document reference TR010034/APP/3.1).

**Legend:**

- Local Authority boundary
- Development Consent Order (DCO) boundary
- Scheme layout (shown for illustrative purposes)
- Existing highways to be stopped up
- Private means of access to be stopped up
- New/alterd private means of access
- Existing Public Right of Way (PRoW)
- PRoW or footway/cycleway to be stopped up/extinguished
- New or diverted combined footway/cycleway with equestrian use
- New or diverted footway
- New or diverted footpath
- New non-segregated footway/cycle track
- New private means of access to maintain ecology mitigation

(8/2) Start/End point of highway / right of way to be improved, diverted, created, stopped up or extinguished  
 (1/a) New signal controlled non-motorised user crossing  
 (A) Existing private means of access to be stopped up  
 (9/i) Other private means of access to be altered

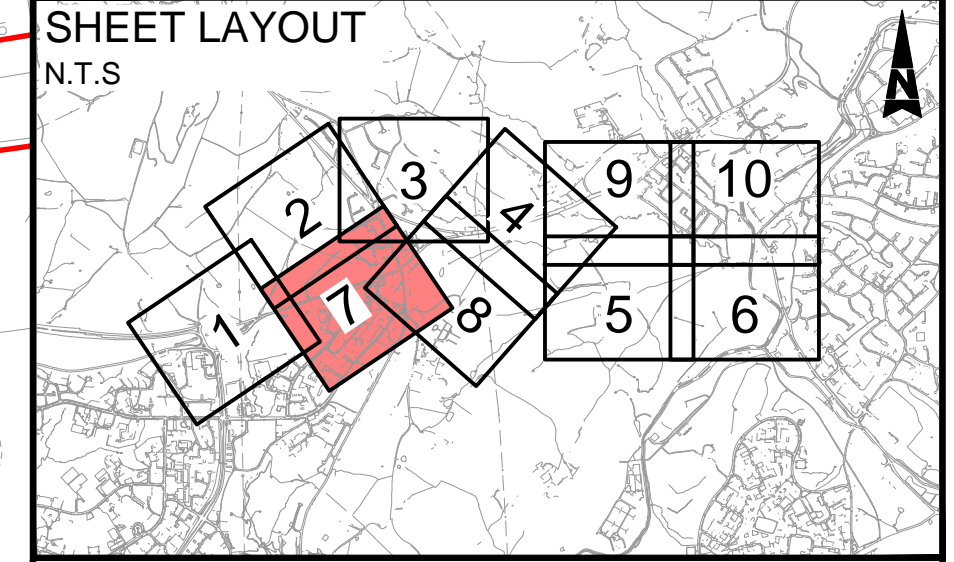

This map is based on Ordnance Survey material with the permission of Ordnance Survey on behalf of the Controller of Her Majesty's Stationary Office. © Crown copyright. Unauthorised reproduction infringes Crown copyright and may lead to prosecution or civil proceedings. Highways England 100030649, 2021.

Status	Revision	Issue Date
Description		
Status	Revision	Issue Date
DCO APPLICATION		
Status	A4	Revision P01
Issue Date	14/05/21	
Description		
Status	A4	Revision P02
Issue Date	17/11/21	
Description		
Updated for Deadline 5		
Status	A4	Revision P03
Issue Date	23/02/22	

Drawing Suitability	DCO APPLICATION	Status	A4
---------------------	-----------------	--------	----



**Scheme Name**  
A57 LINK ROADS

**Drawing Title**  
STREETS, RIGHTS OF WAY AND ACCESS PLANS  
REGULATION 5(2)(k)  
SHEET 7 OF 10

PINS Ref No:		TR010034/APP/2.4	
Drawing Number	Originator	Volume	
HE551473	BBA	LDC	
Location		Type	Role
A57_AL_SCHEME		DR	ZL
Scale:	1:1000 @ A1	Original Size:	A1
Rev:	P03		

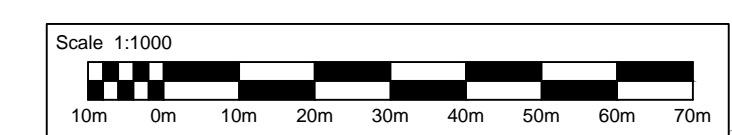



DO NOT SCALE

Millimetres

0 10

100

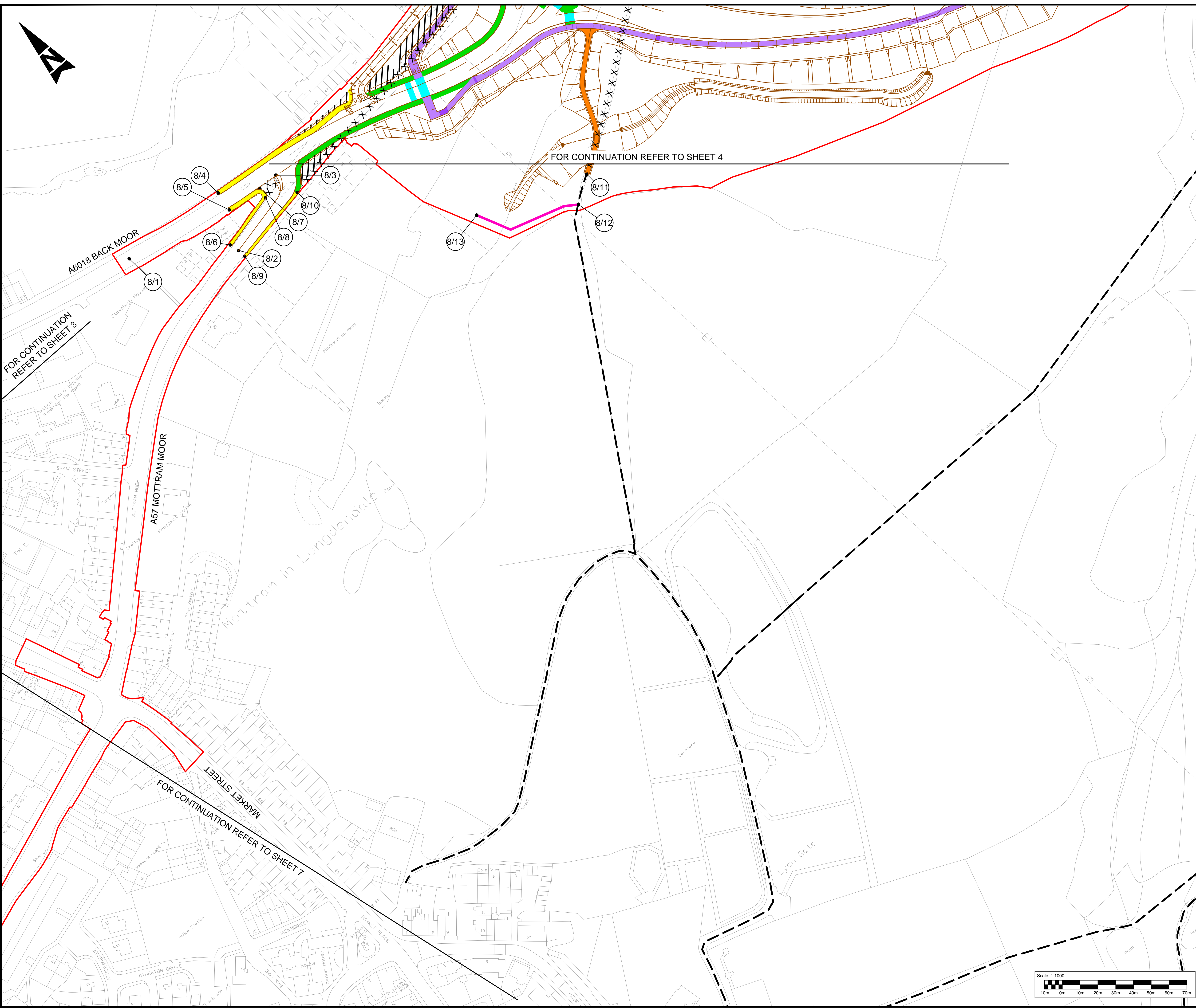

**Notes**

1. These plans should be read in conjunction with Schedules 3 and 4 of the Development Consent Order (application document reference TR010034/APP/3.1).

**Legend:**

- Local Authority boundary
- Development Consent Order (DCO) boundary
- Scheme layout (shown for illustrative purposes)
- Existing highways to be stopped up
- Private means of access to be stopped up
- New/alterd private means of access
- Existing Public Right of Way (PRoW) PRoW or footway/cycleway to be stopped up/extinguished
- New or diverted combined footway/cycleway with equestrian use
- New or diverted footway
- New or diverted footpath
- New non-segregated footway/cycle track
- New private means of access to maintain ecology mitigation
- Start/End point of highway / right of way to be improved, diverted, created, stopped up or extinguished
- New signal controlled non-motorised user crossing
- Existing private means of access to be stopped up
- Other private means of access to be altered

FOR CONTINUATION REFER TO SHEET 3

FOR CONTINUATION REFER TO SHEET 4

FOR CONTINUATION REFER TO SHEET 7

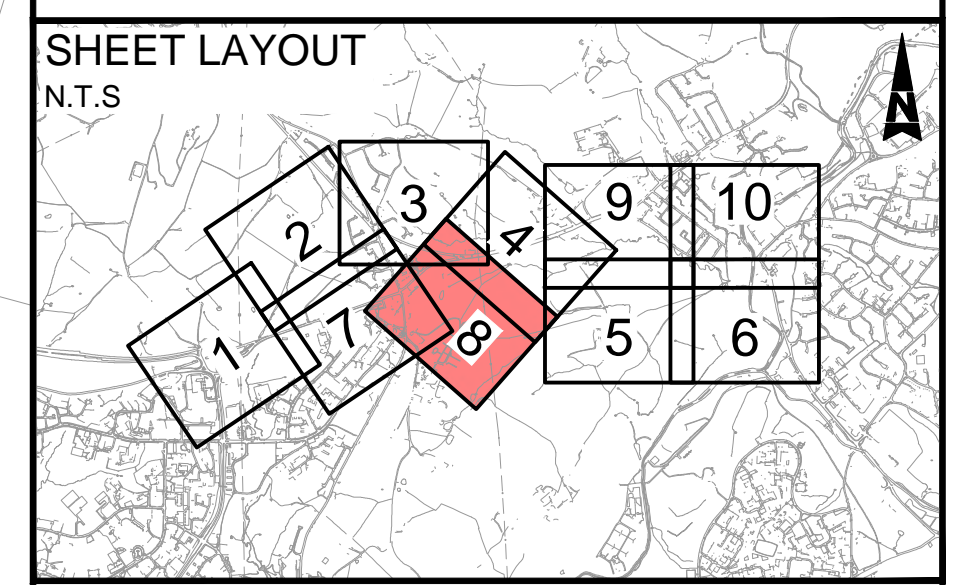

This map is based on Ordnance Survey material with the permission of Ordnance Survey on behalf of the Controller of Her Majesty's Stationary Office. © Crown copyright. Unauthorised reproduction infringes Crown copyright and may lead to prosecution or civil proceedings. Highways England 100036649, 2021.

Description	Status	Revision	Issue Date
DCO APPLICATION	A4	P01	14/05/21
S51 ADVICE	A4	P02	17/11/21
Updated for Deadline 5	A4	P03	23/02/22

Drawing Suitability	DCO APPLICATION	Status	A4
---------------------	-----------------	--------	----



**Scheme Name**  
A57 LINK ROADS

**Drawing Title**  
STREETS, RIGHTS OF WAY AND ACCESS PLANS  
REGULATION 5(2)(k)  
SHEET 8 OF 10

**PINS Ref No:** TR010034/APP/2.4

Drawing Number	HE551473	Originator	BBA	Volume	LDC
Scheme	A57_AL_SCHEME	Type	DR	Role	ZL
Location		Number	020408	Rev	P03

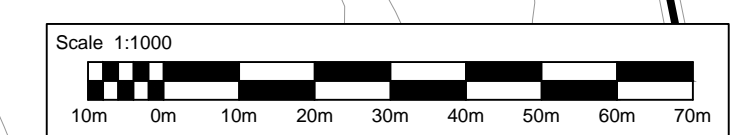



100  
Millimetres

DO NOT SCALE

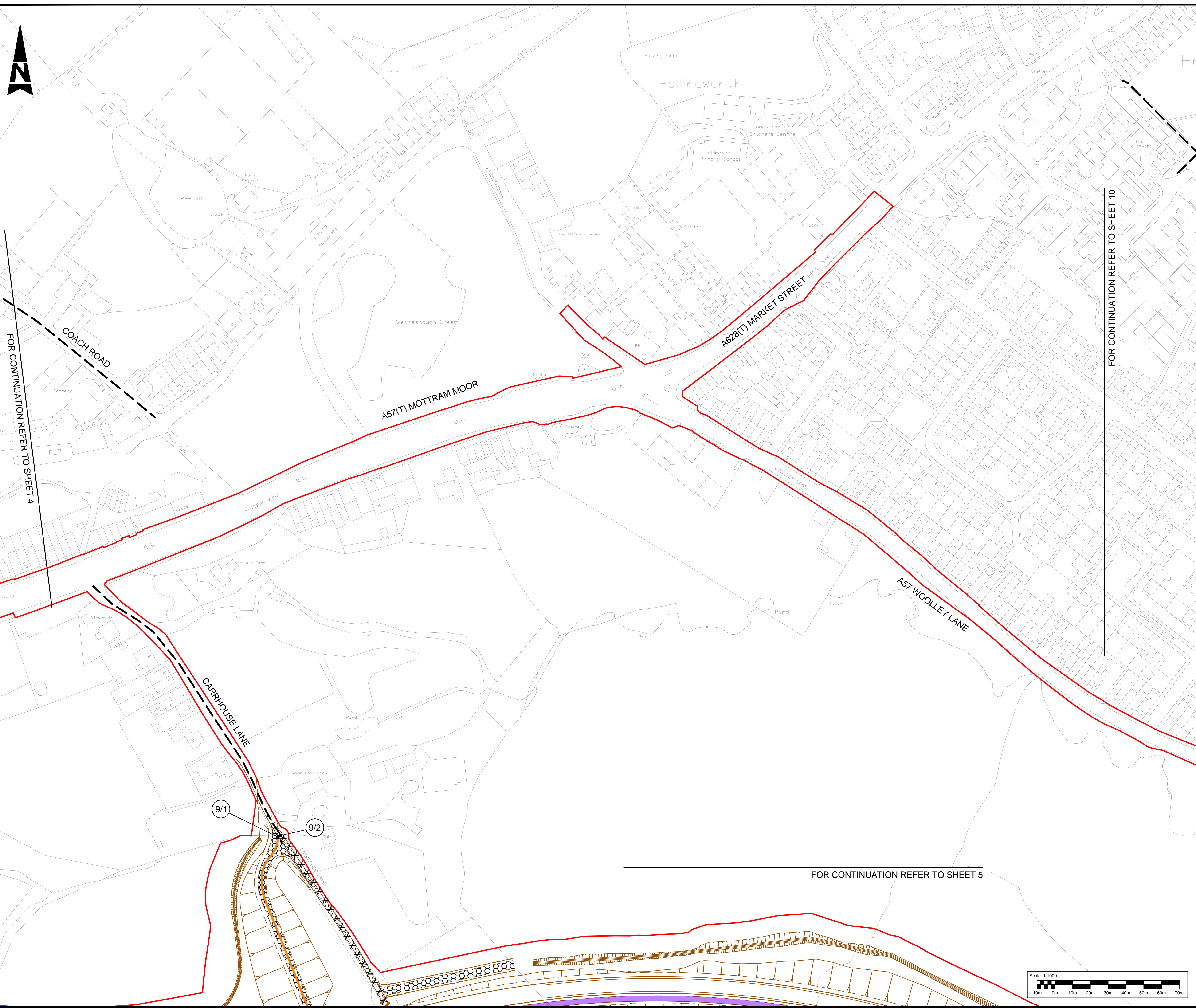

FOR CONTINUATION REFER TO SHEET 4

FOR CONTINUATION REFER TO SHEET 10

FOR CONTINUATION REFER TO SHEET 5

**Notes**

- These plans should be read in conjunction with Schedules 3 and 4 of the Development Consent Order (application document reference TR010034/APP/3.1).

**Legend:**

- Local Authority boundary
- Development Consent Order (DCO) boundary
- Scheme layout (shown for illustrative purposes)
- Existing highways to be stopped up
- Private means of access to be stopped up
- New/alterd private means of access
- Existing Public Right of Way (PRoW)
- PRoW or footway/cycleway to be stopped up/extinguished
- New or diverted combined footway/cycleway with equestrian use
- New or diverted footway
- New or diverted footpath
- New non-segregated footway/cycle track
- New private means of access to maintain ecology mitigation
- Start/End point of highway / right of way to be improved, diverted, created, stopped up or extinguished
- New signal controlled non-motorised user crossing
- Existing private means of access to be stopped up
- Other private means of access to be altered

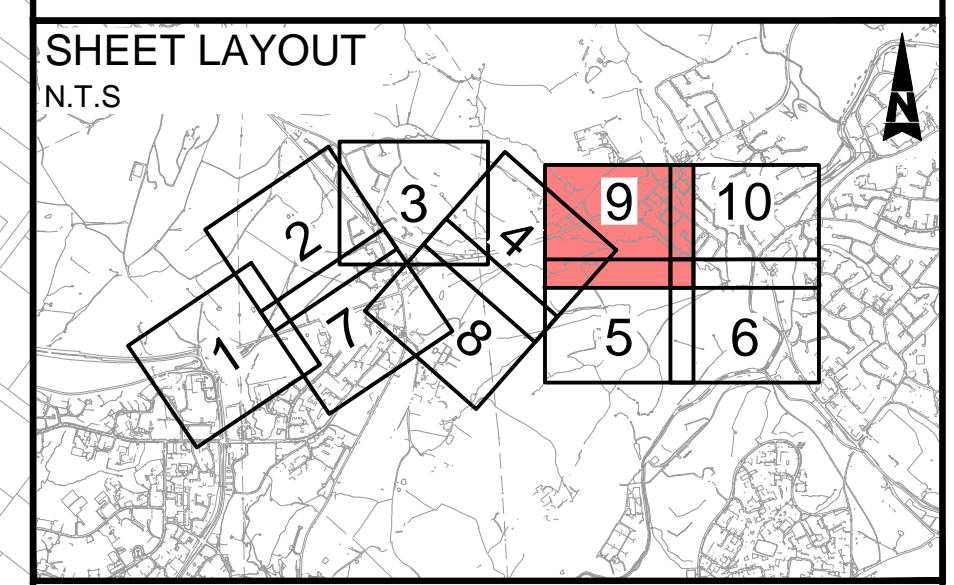

This map is based on Ordnance Survey material with the permission of Ordnance Survey on behalf of the Controller of Her Majesty's Stationery Office. © Crown copyright. Unauthorised reproduction infringes Crown copyright and may lead to prosecution or civil proceedings. Highways England 100030649, 2021.

Description	Status	Revision	Issue Date
DCO APPLICATION	A4	P01	14/05/21
S51 ADVICE	A4	P02	17/11/21
Updated for Deadline 5	A4	P03	23/02/22

Drawing Suitability	DCO APPLICATION	Status	A4
---------------------	-----------------	--------	----



**Scheme Name**  
A57 LINK ROADS

**Drawing Title**  
STREETS, RIGHTS OF WAY AND ACCESS PLANS  
REGULATION 5(2)(k)  
SHEET 9 OF 10

**PINS Ref No:** TR010034/APP/2.4

<b>Drawing Number</b> Scheme	HE551473	<b>Originator</b>	BBA	<b>Volume</b>	LDC
<b>Location</b>	A57_AL_SCHEME	<b>Type</b>	DR	<b>Role</b>	ZL
<b>Scale:</b>	1:1000 @ A1	<b>Original Size:</b>	A1	<b>Rev:</b>	P03

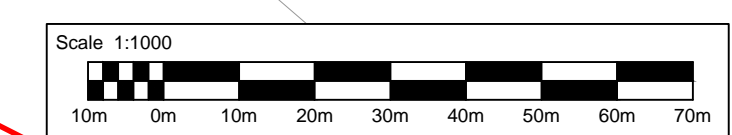



DO NOT SCALE

Millimetres 0 10 100



**Notes**

1. These plans should be read in conjunction with Schedules 3 and 4 of the Development Consent Order (application document reference TR010034/APP/3.1).

**Legend:**

- Local Authority boundary
- Development Consent Order (DCO) boundary
- Scheme layout (shown for illustrative purposes)
- Existing highways to be stopped up
- Private means of access to be stopped up
- New/alterd private means of access
- Existing Public Right of Way (PRoW)
- PRoW or footway/cycleway to be stopped up/extinguished
- New or diverted combined footway/cycleway with equestrian use
- New or diverted footway
- New or diverted footpath
- New non-segregated footway/cycle track
- New private means of access to maintain ecology mitigation
- Start/End point of highway / right of way to be improved, diverted, created, stopped up or extinguished
- New signal controlled non-motorised user crossing
- Existing private means of access to be stopped up
- Other private means of access to be altered

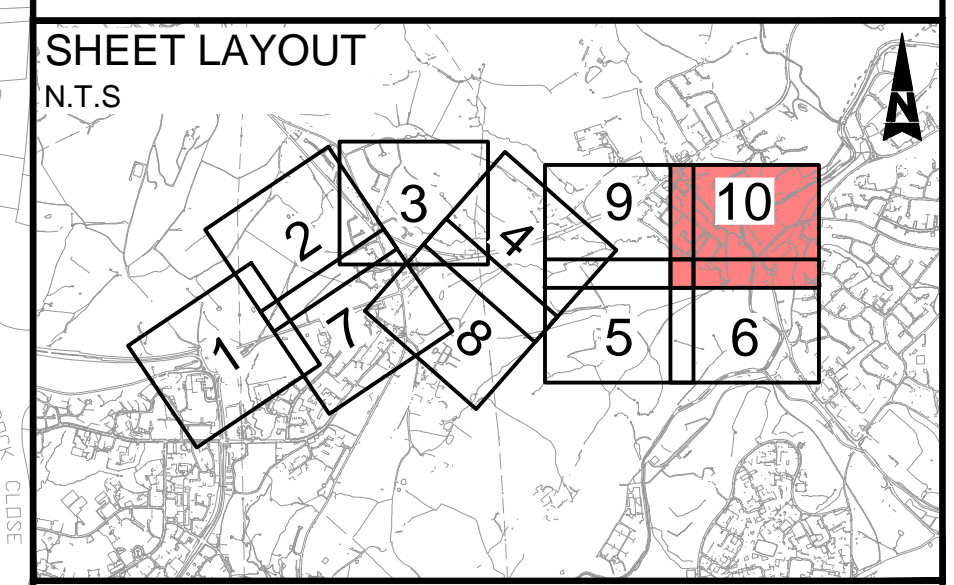

This map is based on Ordnance Survey material with the permission of Ordnance Survey on behalf of the Controller of Her Majesty's Stationary Office. © Crown copyright. Unauthorised reproduction infringes Crown copyright and may lead to prosecution or civil proceedings. Highways England 100030649, 2021.

Description	Status	Revision	Issue Date
DCO APPLICATION	A4	P01	14/05/21
S51 ADVICE	A4	P02	17/11/21
Updated for Deadline 5	A4	P03	23/02/22

DCO APPLICATION	A4
-----------------	----

Client:

Scheme Name: **A57 LINK ROADS**

Drawing Title: **STREETS, RIGHTS OF WAY AND ACCESS PLANS REGULATION 5(2)(K) SHEET 10 OF 10**

PINS Ref No: TR010034/APP/2.4

Drawing Number	Originator	Volume
HE551473	BBA	LDC
Location	Type	Role
A57_AL_SCHEME	DR	ZL
Scale	Original Size	Rev
1:1000 @ A1	A1	P03



© Crown copyright (2022).

You may re-use this information (not including logos) free of charge in any format or medium, under the terms of the Open Government Licence. To view this licence:

visit [www.nationalarchives.gov.uk/doc/open-government-licence/](http://www.nationalarchives.gov.uk/doc/open-government-licence/)  
write to the Information Policy Team, **The National Archives, Kew, London TW9 4DU**,  
or email [psi@nationalarchives.gsi.gov.uk](mailto:psi@nationalarchives.gsi.gov.uk).

Printed on paper from well-managed forests and other controlled sources.

Registered office Bridge House, 1 Walnut Tree Close, Guildford GU1 4LZ  
National Highways Limited registered in England and Wales number 09346363

